

# HellFighter Quick Installation

**WARNING:** Confirm that weapon is unloaded and on SAFE before installation

1. The HellFire light is shipped attached to the T-mount. Before installing, separate them by pushing the release button and moving the lock key to the open position. Slide the light forward to remove it from the T-mount.
2. Use the installation tool to loosen the lock plugs in the T mount.
3. Slide T-mount assembly onto barrel support.
4. Rotate T-mount to align lock plugs with holes on barrel support.
5. Hand tighten all lock plugs evenly. Then use installation tool to tighten plugs securely.
6. To install light assembly, press release button, move lock key to the open position, then slide light assembly onto T mount. Snap the lock key into the locked position.
7. Plug in power cord, then connect cord to power source.

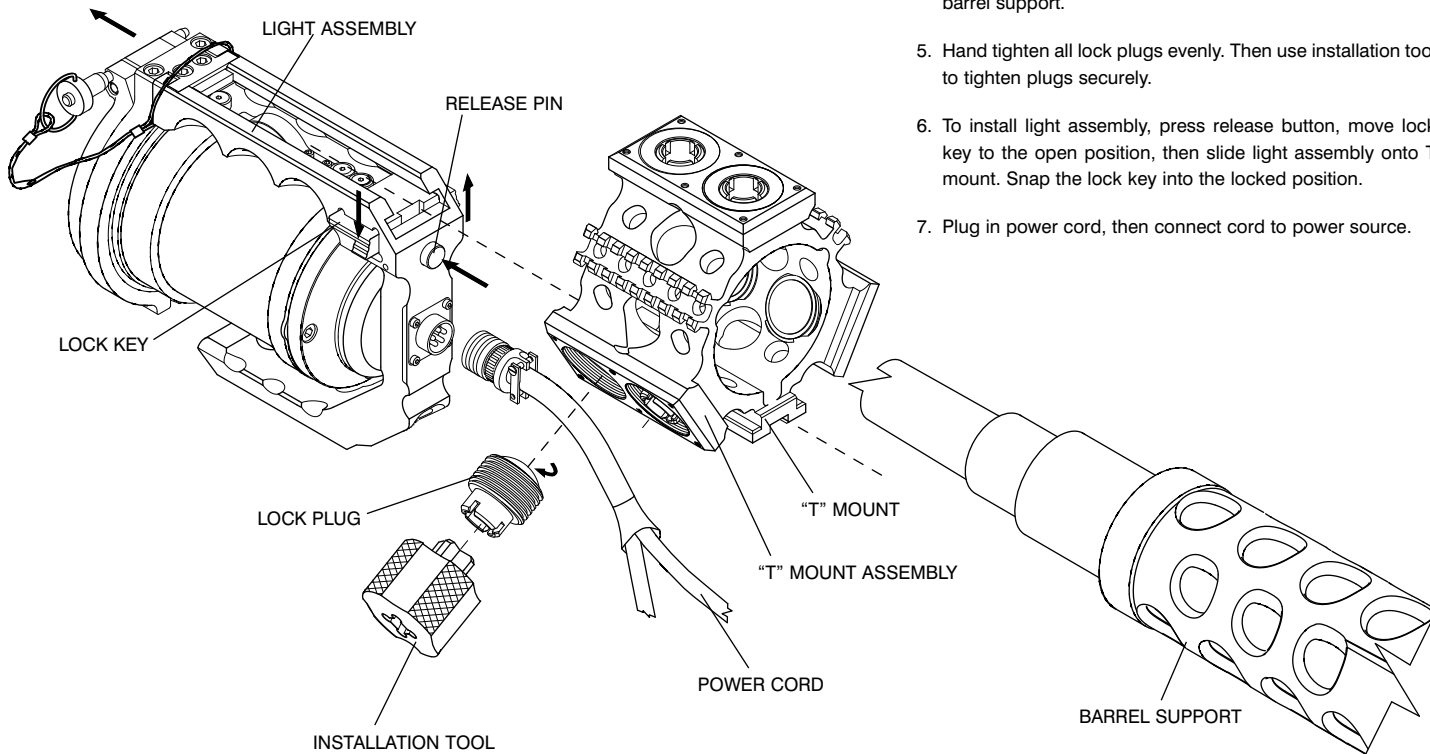

## HELLFIGHTER STORAGE CASE

